

2 Megapixel IP 180° Panoramic Dome CAMERA

FPN-B402-R

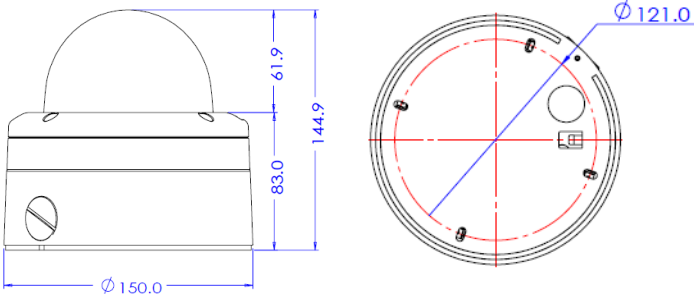

Dimension (unit : mm)



FEATURES

IP Panoramic Bullet Camera for 180° viewing angle
3 sensor (2M) and 4.3mm fixed lens allows to FOV of 180° with resolution of 6MP total.

Patented External Tilt/Rotation device Technology
External Rotation and Tilting patented wired mechanism makes the installer to adjust the camera viewing angle without opening the dome cover. With 8X zoom module will ease to focus.

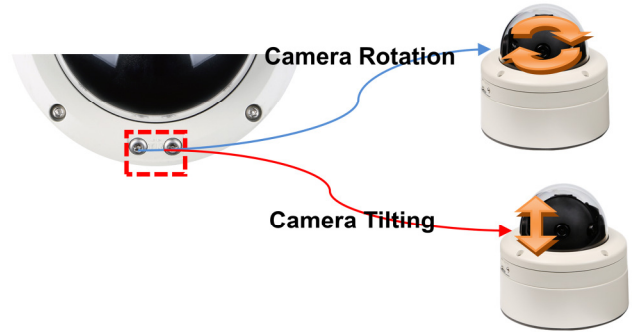

Digital zoom with digital pan
Supports digital zoom with digital pan. Setting preset and preset tour is also available with this digital zoom and pan.

Real-time High Definition Bullet Camera
Using the state of art video compression engine, real time HD video streams of 1080p can be delivered for recording and monitoring.

Dual codec, Simultaneous Multi Streaming
Dual H/W codec enables to transmit max 2 independent streams with different settings for different requirements. Therefore, it is possible to combine seamless remote video monitoring using H.264 and additional MJPEG can be delivered for Mobile devices such as Smart Phone or PDA.

Local SD Card Backup
Some important sequence of still images can be stored in the SDHC memory card. This action can be configured to work with pre-post- alarm event or a given interval.

Day & Night by ICR
For increased sensitivity of image sensor efficiently, a mechanical actuator can shift infrared (IR) Cut filter to disengage from image path automatically in the low light environment.

POE
Built-in Power over Ethernet (IEEE 802.3at) makes installation easier, cheaper and more secure since Power over Ethernet can take advantage of UPS (uninterrupted power supply), which provides back-up power in case of a power failure.

Weather Proof Design
Due to IP66 environment protection as well as speed bullet camera will serve you all the time regardless of rain, snow and storm.

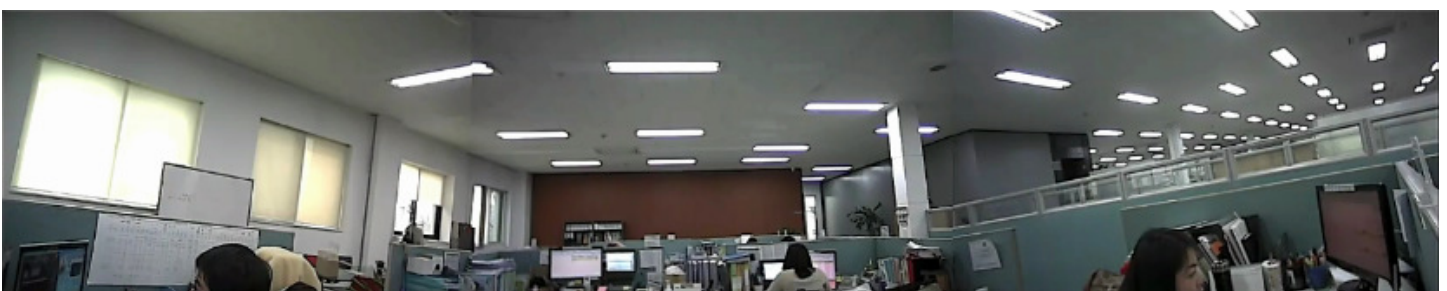

Specification

| CAMERA | |
|-------------------|--|
| Image Device | 1/2.8" 2.4M Sony Sensor * 3ea |
| Resolution | 1920 (H) x 1080 (V) ~360(V) |
| Aspect Ratio | HD: 16:9(1x zoom) ~ 16:3 (1/3x zoom) |
| Focal Length | 4.3mm Board Lens * 3ea |
| Horizontal angle | 180 degree (each lens angle is 70 degree)) |
| MIN. Illumination | COLOR : 0.5Lux @ F2.5, 30IRE B/W : 0.27Lux |
| Day & Night | Auto / Day / Night (ICR) |
| Shutter Speed | Auto / Manual |
| Focus | Manual |
| AGC | Max 41dB |
| White Balance | Auto / Auto-Ext / Indoor / Outdoor / Manual / Preset |
| IR LED | N/A |
| TDN | Filter change mechanism |
| Other Functions | 3D DNR , 3 Sensor out in 1/3x Scale down, 1 Sensor out in 1x zoom |

| GENERAL | |
|-----------------|---|
| Camera Posture | 3 Axis (Pan/Tilt/Rotation) External tilt and rotation adjustment |
| Digital In/Out | 1 Alarm Sensor In / 1 Out |
| Audio In / Out | 1 Audio In / 1 Out |
| Video Out | BNC: VBS 1.0 Vp-p |
| Power | DC 12V 14W, PoE 12W POE IEEE 802.3af |
| Approvals | FCC, CE, IP66, ROHS |
| Housing | Weather proof/Vandal Proof Structure Color: Cool Gray |
| Material | Aluminum Die-casting |
| Dimension | Net (Ø x H) Ø150 x 144.9(H) mm |
| Weight | 2Kg |
| Operating Temp. | -10°C ~ 50°C |

| NETWORK | | |
|--------------------|--|--|
| OS | Embedded Linux | |
| Video Compression | Dual Codec,H.264/MJPEG | |
| Video Streaming | Multi Streaming CBR/VBR (Controllable frame rate and Bandwidth) | |
| Resolution | H.264 : 1080P/D1/CIF/QCIF MJPEG : 1080P/D1/CIF/QCIF | |
| Frame Rate | Max. 30 /25 fps for 1080P/D1/CIF/QCIF | |
| Audio Compression | Two way, G.711 PCM. µ-law 64kbps 8kHz | |
| Local Storage | SDHC memory card (card is not included) | |
| Motion detection | Notification: FTP, e-mail, Alarm out, JPEG Recording on SD | |
| Alarm | Pre-Post Alarm | |
| Max No. of Clients | 10 | |
| Protocols Support | IPv4 | ONVIF, TCP/IP, UDP/IP, RTP(UDP), RTP(TCP), RTSP, NTP, HTTP,HTTPS, SSL, DNS, DDNS, DHCP, FTP, SMTP, ICMP, SNMPv1/v2c/v3(MIB-2) |
| | IPv6 | TCP/IP, HTTP, HTTPS, DHCP |
| | DDNS | Proprietary: NET4C Public DDNS services Support: www.dyndns.com, www.no-ip.com |
| | Security | HTTPS(SSL), Digest Authentication(ID/PW) |
| OS Supported | Windows 7, Vista, XP , 2000 | |