

TCM-5311

H.264 Megapixel IP D/N PoE
CCD Box Camera



- 1/3" Progressive Scan CCD
- Day and night function with mechanical IR cut filter
- Minimum illumination 0.05 lux at F1.2
- DC Iris lens supported
- 15 fps at 1280 x 960 resolution
- Selectable H.264, MPEG-4 SP, MJPEG compressions with dual streaming
- Two-way audio
- Video motion detection
- MicroSD/ MicroSDHC card slot for local storage
- Digital input and digital output
- Powered by PoE Class 3 / DC 12V

PHOTO INDICATION

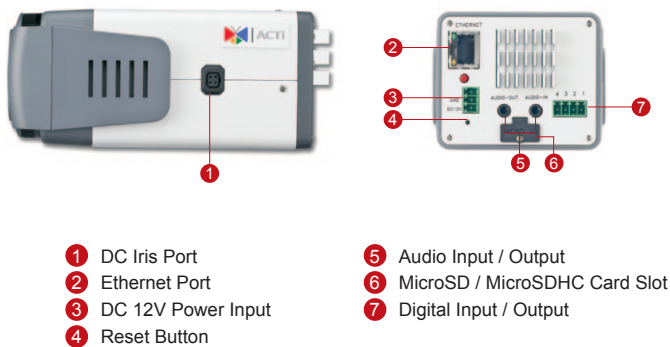

DIMENSION DIAGRAM

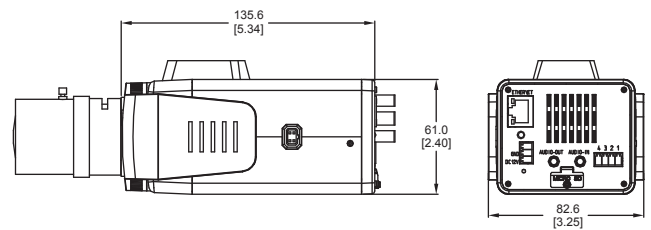

Unit: mm [inch]

ACCESSORY OPTIONS

| Lens | | |
|----------------------------|---|--|
| PLEN-0205 | | IR Compatible, DC Iris, F1.6, 8 mm - 80 mm, 34.4° - 3.7° |
| PLEN-0212 | | IR Compatible, DC Iris, F1.2, 3.1 mm - 8 mm, 89.69° - 35.06° |
| Power Adapter | | |
| PPBX-0002 | | Universal Power Adapter, 100~240V, 4 different connectors included |
| Popular Mounting Solutions | | |
| Corner | PMAX-0200/ PMAX-0201 PMAX-1101 PMAX-0402 | |
| Pole | PMAX-0200/ PMAX-0201 PMAX-1101 PMAX-0502 | |

| Outdoor Housing & Bracket | | |
|---------------------------|--|--|
| PMAX-0200 | | IP66, with heater and fan powered by 110V AC, -30 °C ~ 50 °C (-22 °F ~ 122 °F), requires housing bracket |
| PMAX-0201 | | IP66, with heater and fan powered by 220V AC, -30 °C ~ 50 °C (-22 °F ~ 122 °F), requires housing bracket |
| PMAX-1101 | | Aluminum, max. load 10 kg (22.05 lb), tilt angle 90° (For PMAX-0200, PMAX-0201, PMAX-0202) |
| Camera Bracket | | |
| PMAX-1100 | | Plastic, max. load 3.5 kg (7.72 lb), tilt angle 90° |

* For more mounting solutions, please refer to Mounting Accessory section of Buyer's Guide or Project Planner on www.acti.com

PRODUCT SPECIFICATION

TCM-5311

• Device

| | |
|--------------------------|---|
| Device Type | Box Camera |
| Image Sensor | Progressive Scan CCD |
| Sensor Size | 1/3" (4.8 x 3.6 mm) |
| Horizontal Resolution | 900 TVL |
| Day / Night | Yes |
| Minimum Illumination | Color: 0.15 lux at F1.2 (30 IRE, Max. AGC); B/W: 0.05 lux at F1.2 (30 IRE, Max. AGC) |
| Color to B/W switch | DSP based switch, configurable |
| Mechanical IR Cut Filter | Yes |
| IR Sensitivity Range | 700 - 1100 nm |
| Electronic Shutter | 1/60 - 1/10,000 sec (60Hz); 1/50 - 1/10,000 sec (50Hz) (manual mode) 2 - 1/100,000 sec (auto mode) |

• Lens

| | |
|-------------|-----------------------------------|
| Mount Type | C/CS mount (interchangeable lens) |
| Lens Option | Compatible lenses are available |

• Video

| | |
|-----------------------------------|---|
| Compression | H.264, MPEG-4 SP, MJPEG |
| Maximum Frame Rate vs. Resolution | 15 fps at 1280 x 960; 30 fps at 1280 x 720 (HD 720p); 30 fps at 640 x 480 (VGA); 30 fps at 320 x 240 (QVGA); 30 fps at 160 x 112 (QQVGA) |
| Multi-Streaming | Simultaneous dual streams based on two configurations |
| Bit Rate | 28 Kbps - 6 Mbps (per stream) |
| Bit Rate Mode | Constant, Variable |
| S/N Ratio | More than 50 dB |
| Image Enhancement | Backlight compensation; White balance: automatic, hold, predefined and manual; Brightness; Automatic gain control; Auto exposure: automatic, predefined, manual; Flickerless |
| Privacy Mask | 4 configurable regions |
| Text Overlay | User defined text on video |
| Image Orientation | Image flip and mirror |

• Audio

| | |
|-------------|-----------------------------------|
| Compression | 8 kHz, Mono, PCM, 16 bit encoding |
| Audio-In | 3.5mm Phone Jack |
| Audio-Out | 3.5mm Phone Jack |

• Network

| | |
|--------------------|---|
| Protocol & Service | TCP, UDP, HTTP, HTTPS, DHCP, PPPoE, RTP, RTSP, IPv6, DNS, DDNS, NTP, ICMP, ARP, IGMP, SMTP, FTP, UPnP, SNMP, Bonjour |
| Ethernet Port | 1, Ethernet (10/100 Base-T), RJ-45 connector |
| Security | IP address filtering; HTTPS encryption; Password protected user levels; IEEE 802.1X network access control |

• Alarm

| | |
|----------------|---|
| Alarm Trigger | Video motion detection (3 regions); External device through digital input |
| Alarm Response | Notify control center; Change camera settings; Command other devices; E-mail notification with snapshots; Save video or snapshot to local storage; Upload video, snapshot to FTP server; Activate external device through digital output |

• Interface

| | |
|-------------------|--|
| DC Iris Connector | External connector for DC Iris lens |
| Digital Input | 1, terminal block |
| Digital Output | 1, terminal block |
| Local Storage | MicroSD / MicroSDHC memory card slot (card not included) |

• General

| | |
|----------------------------|--|
| Power Source / Consumption | PoE Class 3 (IEEE802.3af) / 7.68 W DC 12V / 6.72 W (adapter not included) |
| Weight | 505 g (1.1 lb) |
| Dimensions (W x H x D) | 82.6 mm x 61.0 mm x 135.6 mm (3.25" x 2.40" x 5.34") |
| Operating Temperature | -10 °C ~ 50 °C (14 °F ~ 122 °F) |
| Operating Humidity | 10% ~ 85% RH |
| Approvals | Camera: CE, FCC |

• Integration

| | |
|-------------------------|---|
| Unified Solution | Fully compatible with ACTi software |
| ISV Integration | Software Development Kit (SDK) available; ONVIF Compliant |
| Firmware Access Browser | Microsoft Internet Explorer 6.0 or newer |