

DS-2CE16D1T-IR

HD1080P Turbo HD Bullet Camera

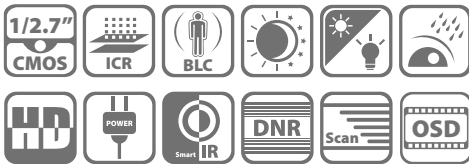

Key features

- HD1080P Video Output
- Adopt HDTVl Technology
- True Day/Night, Smart IR
- 20m IR distance
- IP66 weatherproof
- OSD menu controlled via UTC

Dimensions

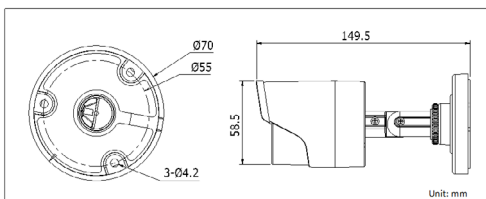

Available models

DS-2CE16D1T-IR

DS-2CE16D1T-IR	
Camera	
Image Sensor	1 / 2.7" Progressive Scan CMOS
Signal System	PAL / NTSC
Effective Pixels	1930(H)*1088(V)
Min. Illumination	0.1 Lux @ (F1.2,AGC ON),0 Lux with IR
Shutter Time	1 / 25(1 / 30) s to 1 / 50,000 s
Lens	3.6mm (6mm optional) Angle of View: 90°(3.6mm), 55.4°(6mm)
Lens Mount	M12
Day & Night	ICR
Angle Adjustment	Pan: 0 - 360°, Tilt: 0 - 90°, Rotation: 0 - 360°
Synchronization	Internal synchronization
Video Frame Rate	1080p@25fps / 1080p@30fps
HD Video Output	1 Analog HD output
S / N Ratio	More than 52dB
Menu	
Camera ID	On / off (0-255)
AGC	Support
D / N Mode	Color/ BW/ Auto/ EXT
White Balance	Auto/ User/ Push/ 8000K/ 6000K/ 4200K/ 3000K
Privacy Mask	On / Off, maximum 2 zones
Motion Detection	On / Off, maximum 4 zones
BLC	Support
Anti-flicker	On / off
Language	English/ Chinese
Functions	Digital noise reduction, Mirror
General	
Working Temperature / Humidity	-40 °C - 60 °C (-40 °F - 140 °F) Humidity 90% or less (non-condensing)
Power Supply	12 VDC
Power Consumption	Max. 3W
Weather Proof Ratings	IP66
IR Range	Up to 20m
Communication	Up the coax Protocol: HIKVISION-C(Coaxitron)
Dimensions	φ70×149.5 mm (φ2.76" ×5.89")
Weight	290 g (0.64 lb)