

# FW1176-MS

H.264/MJPEG 1.3M Plastic Dome Camera



## Key Features

- 1/3" 1.47M PS MOS Sensor
- 2.8-10mm(F1.2) V/F Lens / 3.6-16mm(F1.2) V/F Lens
- Min. Illumination: 0.001Lux
- Max. 30fps@1.3M(1280x1024)
- Dual Stream(H.264, MJPEG)
- Onboard storage by Micro SD
- Built-in PoE (Optional)
- 24 IR LED (Optional)

**Supports both ONVIF(ProfileS) and PSIA(v1.0) standards.**

<b>Video Encoding</b>	H.264/MJPEG(simultaneous dual stream) H.264/H.264 (true H.264 dual streaming) Simultaneous streaming with independent control
<b>Video signal</b>	1 Analog(NTSC only) Output (Optional)
<b>Resolution</b>	1280x1024, 704x480, 352x240, 176x112
<b>Live Casting</b>	Streaming video channels with full duplex live audio Up to max 30fps@ 1.3M when simplex
<b>Audio Encoding</b>	8bit G.711, 8KHz, 8KByte/sec
<b>Audio channels</b>	1ch audio-in & 1ch audio-out
<b>PTZ support</b>	PTZ and UART device control through serial port(RS232 / RS485) (Support protocols; Pelco "P" & "D", Vicon V1311RB, Samsung PTZ, Honeywell PTZ and X10 and Epson Printer)
<b>Serial Interface</b>	COM Port: RS-232, for console, serial input/output device AUX Port for PTZ or other RS485 device Max. Baud rate: 115200 bit/s
<b>Bandwidth Management</b>	Frame rate control / Bandwidth control / CBR / VBR [ Trigger Condition ] Video loss / Video recovered / Motion detection (144 area) / Boot finished / Schedule
<b>Alarm Management</b>	[ Alarm Service ] Image holding service (Max 5.6MByte pre-post alarm buffer), Image upload service through E-mail / FTP (support pre & post), Notification service through TCP / UDP / HTTP
<b>Security</b>	Channel based user password protection for live-cast, PTZ, alarm output and audio
<b>Dynamic IP</b>	Dynamic IP service using www.ipcctvdns.com
<b>Smart Solution</b>	Smart Phone Application (IOS, Android)
<b>Web interface</b>	Live-cast, PTZ control, search through Web browser Minimum PC requirement - Windows XP Pro (IE 6.x or later) , Pentium4 (2Ghz, 2G RAM), Video Card(256MB RAM, 1024x768)
<b>Management Software</b>	Supports 16, 32, 64, 128ch Management Software Full-featured PC NVR with matrix functionality
<b>System Integration</b>	[ Protocol ] HTTP, RTP/RTSP, TCP/IP, FTP, Telnet, RARP, PPPoE, SNMP, PAP, CHAP, DHCP, NTP, SMTP client, uPNP, and etc. [ SDK ] Open HTTP API / ActiveX for live cast with audio & PTZ [ Service ] Image upload / notification service / service for POS integration

<b>Installation &amp; maintenance</b>	Configuration by installation wizard, HTTP, telnet and console. Upgrade firmware through HTTP, telnet & FTP
<b>Misc.</b>	Transmit serial input data with video Quick Time & VLC media player compatible
<b>System hardware</b>	32bit Embedded CPU / Embedded Linux / 128MByte SDRAM / 128MByte NAND Flash
<b>Power</b>	Power Supply - SMPS 12V (1A) [AC100-240V, 50/60Hz, 300mA] Max. Power Consumption - DC12V, 6W
<b>Approvals</b>	KC, FCC, CE, RoHS
<b>Dimension / Weight</b>	148 Ø x 121 (H) (in mm) 560g without Power Supply
<b>External Interface</b>	10/100-Base-T Ethernet (auto-sensing) 1 photo-coupled or 1 digital inputs (NC/NO selectable), 1 relay outputs 1 audio input / 1 audio output 2 serial ports (COM: RS-232, AUX: RS-485) 1 Micro SD memory interface Factory Default Button
<b>Working Environment</b>	Temperature: 0-50 °C, Humidity: 20-80% RH
<b>Image sensor</b>	1/3" progressive scan MOS Total pixels 1376H x 1070V, 1.47M Pixel size : 3.75 (H) µm x 3.75 (V) µm Color filter Bayer arrangement of primary colors: R, G, B Bit number of internal ADC: 12 bits Parallel output: 54 MHz, 12 bits Output frame rate: 30 fps
<b>Lens</b>	2.8-10mm, V/F, F1.2 / 3.6-16mm, V/F, F1.2 Day & Night (Auto/B&W/Off) Auto White Balance Noise Filter (Off/On) Brightness/Contrast/Sharpness/AGC Gain Control Lens Type (DC/Manual)
<b>Image Setting</b>	Shutter (Manual/Auto) Vertical/Horizontal Flip Sens Up Level Frequency Control (50/60)
<b>Minimum illumination</b>	0.001 Lux
<b>Options</b>	Built-in PoE (IEEE 802.3af) 24 IR LED

## Dimensions

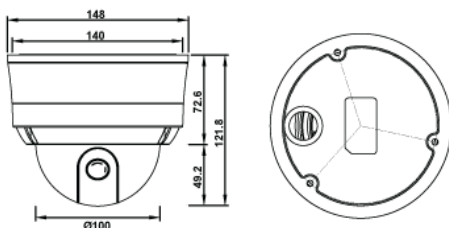

## Accessory