



Features

- 1CH Input BNC Type Composite Video Signal Auto Detect (NTSC/PAL)
- 1CH Video Loop Back (BNC Type)
 - Select NTSC/PAL 1.0Vp-p (BNC Type)
- Built-in System / Network / Event Status LED
- Dual Stream MJPEG / H.264(or MPEG4) Resolution D1 up to 30(25)fps
- Support Two-way Audio (ADPCM)
- Support Local Storage by SD Memory Card
- Ethernet 10/100 Base-T
- (Support PoE)

XNET Applications



Plug & Easy Play over IP

XNET supports plug and play with wizard installer. Auto system configuration and easily user setup by XNET applications.

- Simple install for network and systems setup
- Simultaneously systems setup
- Support UPnP, Bonjour for easy installation



Rear Part



Dimensions

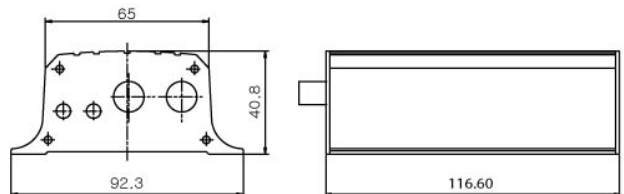

XNET CMS / XNET NVR

CNB XNET CMS/ NVR is the world first software that combines alarm monitoring and video surveillance seamlessly

- Multi-level user group / Interactive E-Map
- User-friendly windows-shell design with docking station utility panels
- Interactive Control, Triple monitors
- Easy to Use, All-in-One screen
- Compatible with various NVS, IP Camera, NVR in a System



XNET APP (XNET Alliance Partner Program)

CNB XNET Products support Open-API for partners. Supplying a dynamic SDK based on API for various IP security environment. Join hands with XNET Alliance Partner Program, you can make a stable and strong IP security environment with improving your CMS and NVR.



[SDK Package Items]

- Sample Program and System Library for debug
- Release Mode Sample Method
- Documentation for SDK
- Sample Header File
- Library(debug/release)
- Sample Source Code (by Visual Studio 2005)

XNET Main Feature



Hybrid IP Technology

XNET can support Hybrid technology. At a standard analog CCTV BNC composite connection for CCTV system. At the same time, monitoring image over IP.



Dynamic Dual Stream

XNET can support dual streaming for multi-client. H.264(or MPEG4) and MJPEG images can be output at the same time. User can see live monitoring with H.264(or MPEG4) and MJPEG based high quality stream image saving to storage.

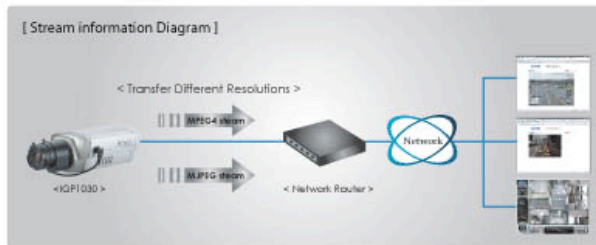

Multiple Event Trigger

XNET also includes activity motion / sensor detection. Easily defined event setting and on-screen display. Activity detection events, XNET supports trigger event output over IP and can save the event image.



Storage Over IP

XNET built-in local storage for pre/post alarm, event image and local saving function. Event (motion and alarm) recording on the local storage is also possible by internal memory. SD memory card can be used as a second storage option.



Built-in PoE(Power over Ethernet)

Saving the installation cost, just do connect the cable to a PoE network hub or PoE network adaptor for easy installation with XNET IP product. CNB all IP products are standard IEEE 802.3af supported. (Optional)

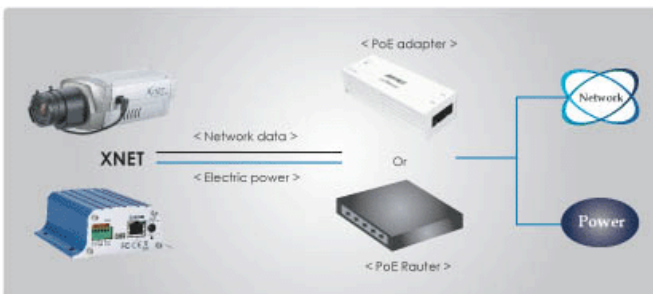

Specifications

INS2000		Specifications
Video Signal	Input Signal	1ch Input BNC type Composite
	Signal Select	NTSC/PAL (Manual)
	Video Output Level	1ch Video Loop Back (BNC type - 75Ω, composite)
System	Main Processors	32bit Embedded CPU with Linux
	System Memory	NAND Flash Memory : 64MByte, 128MB DDR Memory SD Card : Support for Max 4GByte Size
Video / Audio	Compression	MJPEG / MPEG4 / H.264
	Frame rate	Dual Mode : MJPEG (15fps, NTSC/PAL) MPEG4 / H.264 (30fps, NTSC) *PAL(25fps)
	Resolution	D1 (NTSC: 704 x 480 / PAL: 704 x 576) CIF (NTSC : 320 x 240 / PAL: 352 x 288)
	Video streaming	MJPEG / MPEG4(or H.264) Dual mode Constant and variable bit rate in MPEG4 (128kbps ~ 3M bps) Controllable frame rate and bandwidth
	Image settings	Compression level setting Configurable Brightness, Sharpness, White Balance
	Audio	Two-way (full duplex / ADPCM G.726)
Network	Protocol	IPv4, HTTP, TCP, RTSP, RTP, RTCP, UDP, SMTP, FTP, ICMP, DHCP, UPnP, Bonjour, ARP, DNS, DynDNS
	Supported DDNS	1. CNB DDNS 2. DynDNS.org 3. Reference code with SDK
	Video access from Web browser	Camera live view for up to 10 clients
	LAN Interface	Ethernet 10/100 Base-T (RJ-45 Type)
	Support PoE	Standard IEEE 802.3af supported
Security	Access level setup	Multiple user access levels with password protection
	Network Security	IP Filtering
Alarm and Event Management	Image detection	Motion detection (Select 3 Regions - each area)
	Sensor detection	Sensor In, Scheduling, Alarm out
	After Event process	JPEG Image upload over FTP server / SMTP (E-mail server)
	Local storage	JPEG Image write to Internal & SD card memory - Internal memory : Max 32MByte - SD memory : Support size Max 4GByte
	Pre / Post alarm	Detail time-set : Max Pre alarm 5 sec / Post alarm 8 sec Local storage (Internal memory or SD card memory : JPEG image)
Applications	Browser	Internet Explorer 6.0 over
	Monitoring Application	Web Viewer (Window Web Browser Base) Live view for up to 10 user clients Video Snapshot & recording to file (JPEG file)
		XNVR Viewer and Utility (IP-Installer, etc)
Maintenance	System Upgrade	Firmware upgrade over HTTP
	PTZ control (RS-485)	PTZ Protocol Service (User define update)
Mechanical	Operating Temperature	0°C ~ 40°C
	Power	DC 12V Max. 5 W