



Making Security Easier.

## GKB P5007 PnP IP Camera

Plug-and-Play Weatherproof IP Camera with Built-In Infrared

GKB P5007 is a network-ready camera for outdoor use in residential and small-business surveillance installations. GKB P5007 delivers plug-and-play (PnP) networking when used with GKB zIP View™ software and this all-in-one design features weatherproof housing, built-in infrared and mounting bracket.

### Features:

- Plug & Play

GKB P5007 is a plug & play IP camera that makes network set-up easy. Once installed, set-up is as simple as entering ID and password using GKB zIP View™ software.

- 3G Mobile Access

GKB P5007 enables 3G mobile surveillance by RTSP. With mobile version NVR, surveillance is done by simply entering ID and password, on most mobile phones of Windows Mobile, Symbian, and iPhone OS.

- Built-in Infrared

Infrared sensors inside the camera's housing provide the ability to capture images during night and low-light conditions.

- MPEG4 Video Compression

GKB P5007 features MPEG4 video compression for superior video quality. Image quality is enhanced by avoiding the conversion of analog signals to digital before transmission.

- Weatherproof Housing

Weatherproof housing allows GKB P5007 to be installed in most applications and environments, including in summer, winter, sunny day or rainy day; making it an ideal camera for outdoor surveillance.



### Alternate Views



## GKB P5007 PnP IP Camera

Video	Image Sensor	1/3" Sony CCD
	Number of Effective Pixels	NTSC: 510(H) * 492 (V) PAL: 500(H) * 582 (V)
	Video Compression	MPEG 4
	Video Streams	2
	Resolution	176 * 120, 352 * 240, 720 * 480
	Frame Rate	Up to 30 FPS in All Resolution
	Min. Illumination	0.5 Lux, 50 IRE, F1.4
	Gamma	0.45
	S/N Ratio	>48 dB
	Sync. Mode	Internal Sync
	Scanning System	2:1 Interlace
	Shutter Control	NTSC: 1/60-1/100,000 sec. PAL: 1/50-1/100,000 sec.
	BNC Video Output	Composite Video 1.0Vpp, 75 ohm
	Night Mode	Auto
	White Balance	ATW
Infrared LED	Quantity	28
	Peak Wavelength	850 mm
	Radiant Distance	20 meters
Power	Power Supply	12V DC
	Power Consumption	18 W
Lens	6 mm board lens (standard); 8 mm (option)	
Dimension	118 (L) * 78 (Ø) mm	
Weight	0.45 kg	
Ingress Protection Rating	IP66	
Operating Temperature	-10°C ~ +60°C	
Network	Protocol	HTTP, TCP, ICMP, RTSP, RTP, UDP, IGMP, RTCP, SMTP, FTP, DHCP, UPnP, ARP, DNS, and PPPoE
	Ethernet	10/100M Fast Ethernet RJ-45 Port
Software	Operating System	Windows XP and above
	Software Package	zIP View™ (36CH. Management Software)

### Dimensions

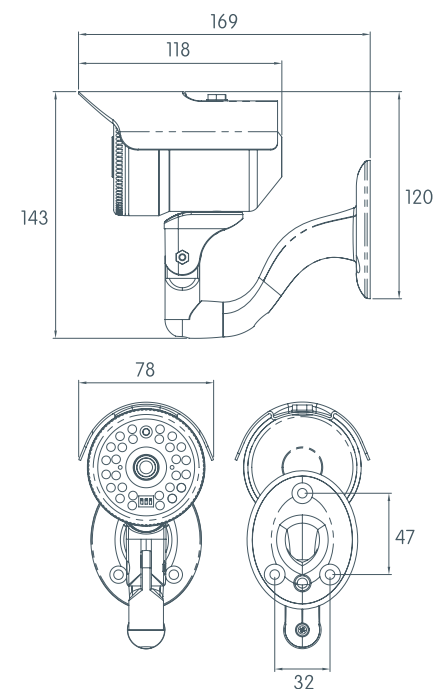

### Optional Accessories



Server