

DS-6508/6516HCI-SATA Digital Video Server

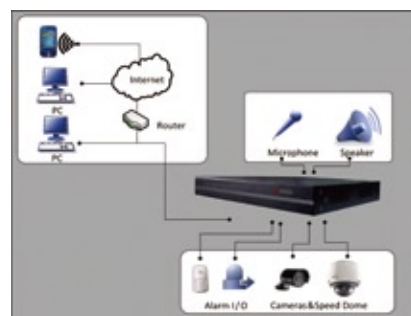

Key Features

- High performance DSP hardware compression
- H.264 video compression
- Dual stream
- Variable bit rate and frame rate
- Multi-zone motion detection and private masking
- Multi-level user access management
- 1 SATA interface for local storage



Specifications

		DS-6508HCI-SATA	DS-6516HCI-SATA
Video/Audio input	Video Compression	H.264	
	Video input	8-ch, BNC(1Vp-p, 75Ω)	16-ch, BNC(1Vp-p, 75Ω)
	Audio compression	OggVorbis	
	Audio input	8-ch, BNC(2Vp-p, 1kΩ)	16-ch, BNC(2Vp-p, 1kΩ)
	Voice talk input	1-ch, MIC connector	
Video/Audio output	Video loop out	DB26 connector (Optional)	
	Audio output	1-ch, MIC connector(2Vp-p, 1kΩ)	
	Recording resolution	QCIF/CIF/2CIF/4CIF	
	Frame rate	4CIF: 8fps 2CIF: 16fps, CIF: 25(P)/30(N)fps	4CIF: 2fps 2CIF: 12fps, CIF: 25(P)/30(N)fps
	Video bit rate	32Kps~1024Kbps, or user-defined	
Hard disk	Dual Stream	Supported	
	Stream Type	Video/ Video&Audio	
External interface	Type	SATA interface	
	Capacity	Up to 2TB	
	Network interface	1RJ45 10/100/1000Mbps self-adaptive UTP Ethernet interface	
	Serial interface	1 RS485, 1 RS232(DB9 Port)	
	USB interface	-	
Others	SATA interface	1	
	Alarm in	16	
	Alarm out	4	
	Chassis	1U, 19-inch; Rear panel provides Reset button	
	Power supply	100~240VAC, 6.3A, 50~60Hz	
	Consumption	≤40W (without HDD)	
	Working temperature	-10°C~+55°C(14°F~131°F)	
Working humidity	10%~90%		
Dimension	440(D)×300(W)×45mm(H)(17.32"(D)×11.81(W)×1.77"(H))		
Weight (without HDD)	≤5000g(11.02lbs)		