

ECD-1000

9-Channel Megapixel H.264 Video Decoder



- Special decoder for large TV panels away from video control room
- Video source up to 2-Megapixel supported
- HDMI output with 1080p resolution
- BNC output for NTSC or PAL standard
- Easy Installation with surface, VESA or pole mounts
- USB port for mouse control
- Powered by PoE Class 3 / DC 12V

PHOTO INDICATION

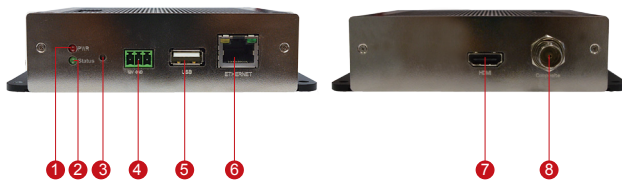

- | | |
|----------------------|-----------------------------------|
| 1 Power LED | 5 USB Port |
| 2 System Ready LED | 6 Ethernet Port |
| 3 Reset Button | 7 HDMI Port |
| 4 DC 12V Power Input | 8 Analog Video Output (Composite) |

DIMENSION DIAGRAM

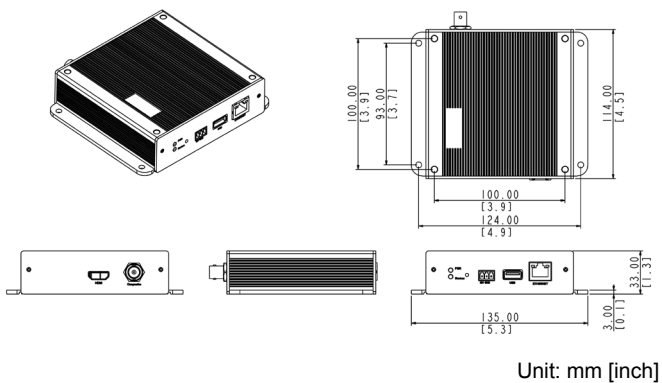

MOUNTING SOLUTIONS

Surface Mount | Accessories not required

Pole Mount (Bundled)



VESA Mount

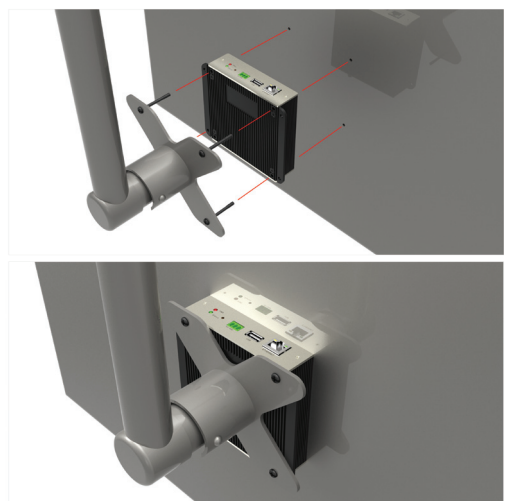

PRODUCT SPECIFICATION**ECD-1000****• Device**

Device Type	Video Decoder
Number of Channels	9

• Video Source

Resolution	Up to 2-Megapixel
Frame Rate	1~30 fps
Compression	H.264
Bitrate	27Mbps

• Video Output

Video Layout	1, 2, 4, 9, 1+5, 1+7, 2+4
Output Standard	HDTV standard up to 1080P, 25/30/50/60Hz; NTSC standard (equivalent to 720 x 480); PAL standard (equivalent to 720 x 576)
Maxium Frame Rate v.s. Resolution	1920x 1080: 30fps at 4-Channel; 12 fps at 9-Channel; 1280 x 1024: 30fps at 6-Channel; 20 fps at 9-Channel 1280 x 720: 30fps at 7-Channel; 25fps at 9-Channel 640 x 480: 30 fps at 9-Channel

• Network

Protocol & Service	TCP, UDP, IP, HTTP, DHCP, RTP, RTSP, ICMP, ARP
Ethernet Port	1, Ethernet (10/100 Base-T), RJ-45 connector
Security	Password protected user levels

• Alarm

Alarm Trigger	Network loss
Alarm Response	Beep

• Interface

Analog Video Output	1, BNC connector
HDMI Output	1, HDMI Type A
USB	1, USB 2.0

• General

Power Source / Consumption	PoE Class 3 (IEEE802.3af) / 8.5 W DC 12V / 7 W
Weight	566 g (1.25 lb)
Dimensions (W x H x D)	135 mm x 114 mm x 33 mm (5.3" x 4.5" x 1.3")
Bundled Accessories	1 bracket, Mount for 1"-2" diameter pipe; Power Adapter
Mount Type	Surface, Pole, VESA (10 cm x 10 cm)
Operating Temperature	0°C ~ 50°C (32°F ~ 122°F)
Operating Humidity	10% ~ 85% RH
Approvals	CE (EN 55022 Class B, EN 55024), FCC (Part15 Subpart B Class B)

• Integration

Unified Solution	Fully compatible with ACTi cameras, encoders
Firmware Access Browser	Microsoft Internet Explorer 9.0 or newer

* All specifications are subject to change without notice.

* All brand names and registered trademarks are the property of their respective owners.

www.acti.com