

EDN850H

Outdoor True Day/Night IP Dome Camera



neVIO Series

Features

- H.264/PJEG-4/MJPEG digital signal output with up to 30 FPS at full D1
- H.264/MPEG4/MJPEG output for simultaneous live monitoring and high resolution recording
- Supports 4 independent video streams that can provide different compression formats and resolutions
- 12VDC and Power Over Ethernet (PoE) IEEE 802.3af
- BNC test monitor output for the convenience of quick focus and diagnostics right at the camera site
- Vandal and Weather Resistant
- Built-in SD memory card slot for local storage (supports SDHC)
- Built-in Dynamic Noise Reduction (DNR) for noise reduction and a 70% saving of disk storage
- Smart Wizard settings for various event & schedule recordings

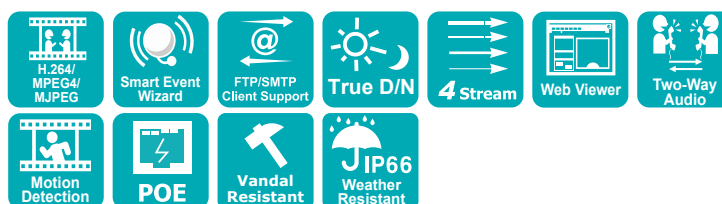

Specifications

Part Number	EDN850H
Pickup Device	1/3" Sony Super HAD Interlaced CCD
Effective Pixels	NTSC: 768 (H) x 494 (V)/ PAL: 752 (H) x 582 (V)
Sensitivity	0.002 Lux/F=1.2 (SENS-UP x128), 0.25 Lux/F=1.2
Day/Night	True Day/Night
Lens	Vari-focal with auto iris 2.8-10mm lens
Video Output	BNC socket, composite 1.0Vp-p/75 ohm
Video Resolution	NTSC: 4CIF (720X480), VGA (640X480), CIF (352X240), QVGA (320X240), QCIF (176X144)
Video Compression	H.264/MPEG4/MJPEG
Video Quality	8 levels adjustable
Frame Rate	up to 30 FPS at full D1
Interface	10Base-T/100Base-TX auto-negotiation, FJ-45 socket. Supports MDI/MDI-X auto cross function
Supported Protocols	HTTP, TCP/IP, FTP, SMTP, DHCP, DNS, DDNS, NTP
Bandwidth Control	Min. 64 k bit per sec. adjustable
Max Client Limit	32 clients simultaneously
Power Over Ethernet	Yes (PoE 802.3af)
Alarm Input	1
Alarm Output	1
Audio In/Out	3.5mm mono line input/ line out
Compression	method IMA ADPCM (Pulse Code Modulation)
Operation Mode	Two-way audio
Event Trigger	Alarm Input, Manual Trigger, Motion Detection and Schedule Recording
Notification	Trigger alarm output, email notification, upload video to FTP, record video to SD card, record video to PC and network alarm
Pre/Post Alarm Buffer	48MB RAM reserved for pre-alarm (record up to 120 sec.)
SD Card	Supports SD and SDHC for local storage
Power Supply	12VDC & PoE
Power Consumption	5W max. (12VDC)
Weight	1.2 lbs
Dimension	5" x 4.4"
Operating Temp	0°C - 40°C/ 32°F - 104°F
Humidity	<90% not condensing
Rating	IP66 Weather Resistant
Certifications	CE, FCC, RoHS

Dimensions: mm/in

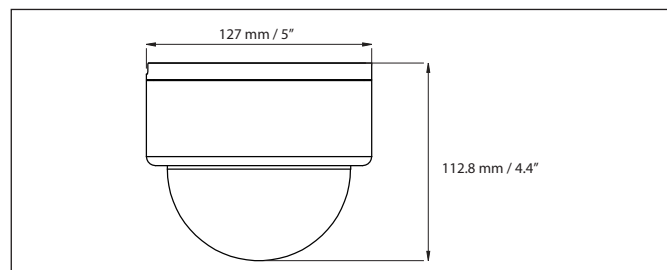

Ordering Info

EDN850H: IP Dome, 560 TVL, 2.8-10mm

