

FW1175-DS

H.264/MJPEG D1 Vandal Dome Camera



Key Features

1/3" 410K PS SUPER HAD CCD Sensor

2.8-10.5mm(F1.2) V/F Lens

Min. Illumination: 0.0002Lux

Max. 30/25fps@D1(720x480/720x576)

Dual Stream(H.264, MJPEG)

Onboard storage by Micro SD

Built-in PoE (Optional)

24 IR LED (Optional)

Supports both ONVIF(ProfileS) and PSIA(v1.0) standards.

Video Encoding	H.264/MJPEG(simultaneous dual stream) H.264/H.264 (true H.264 dual streaming) Simultaneous streaming with independent control
Video signal	1 Analog Output (loop through)
Resolution	720x480(720x576), 704x480(704x576), 352x240(352x288), 160x112(160x112)
Live Casting	Streaming video channels with full duplex live audio Up to max 30fps@ D1 when simplex
Audio Encoding	8bit G.711, 8Khz, 8KByte/sec
Audio channels	1ch audio-in & 1ch audio-out
PTZ support	PTZ and UART device control through serial port(RS232 / RS485) (Support protocols; Pelco "P" & "D", Vicon V1311RB, Samsung PTZ, Honeywell PTZ and X10 and Epson Printer)
Serial Interface	COM Port: RS-232, for console, serial input/output device AUX Port for PTZ or other RS485 device Max. Baud rate: 115200 bit/s
Bandwidth Management	Frame rate control / Bandwidth control / CBR / VBR [Trigger Condition] Video loss / Video recovered / Motion detection (144 area) / Boot finished / Schedule
Alarm Management	[Alarm Service] Image holding service (Max 5.6MByte pre-post alarm buffer), Image upload service through E-mail / FTP (support pre & post), Notification service through TCP / UDP / HTTP
Security	Channel based user password protection for live-cast, PTZ, alarm output and audio
Dynamic IP	Dynamic IP service using www.ipcctvdns.com
Smart Solution	Smart Phone Application (IOS, Android)
Web interface	Live-cast, PTZ control, search through Web browser Minimum PC requirement - Windows XP Pro (IE 6.x or later) , Pentium4 (2Ghz, 2G RAM), Video Card(256MB RAM, 1024x768)
Management Software	Supports 16, 32, 64, 128ch Management Software Full-featured PC NVR with matrix functionality
System Integration	[Protocol] HTTP, RTP/RTSP, TCP/IP, FTP, Telnet, RARP, PPPoE, SNMP, PAP, CHAP, DHCP, NTP, SMTP client, uPNP, and etc. [SDK] Open HTTP API / ActiveX for live cast with audio & PTZ [Service] Image upload / notification service / service for POS integration

Installation & maintenance	Configuration by installation wizard, HTTP, telnet and console. Upgrade firmware through HTTP, telnet & FTP
Misc.	OSD (On-Screen Display) Transmit serial input data with video Quick Time & VLC media player compatible
System hardware	32bit Embedded CPU / Embedded Linux / 128MByte SDRAM / 128MByte NAND Flash
Power	Power Supply - SMPS 12V (1A) [AC100~240V, 50/60Hz, 300mA] Max. Power Consumption - DC12V, 6W
Approvals	IP66, KC, FCC, CE, RoHS
Dimension / Weight	148 Ø x 121 (H) (in mm) (1.0 kg impact-resistant casing) 940g without Power Supply
External Interface	10/100-Base-T Ethernet (auto-sensing) 1 photo-coupled or 1 digital inputs (NC/NO selectable), 1 relay outputs 1 audio input / 1 audio output 2 serial ports (COM: RS-232, AUX: RS-485) 1 Micro SD memory interface Factory Default Button
Working Environment	Temperature: -10~50 °C, Humidity: 10~90% RH
Image sensor	1.3" 410K SUPER HAD CCD Resolution: 560 TV Lines for color / 700 TV Lines for B/W S/N ratio: 52dB or more(AGC OFF, Weight ON) Electronic shutter speed 1/60(50) ~ 1/120,000 sec Sens-up: AUTO/FIXED/OFF(selectable limit x2 ~x256) White Balance: ATW/AWC/Manual Outdoor(1800k, 10,500K)/Indoor(4500K~8500K) Output frame rate: 30 fps
Lens	2.8-10.5mm, V/F, F1.2
Image Setting	Color mode (Color/Gray) Hue/Saturation/Contrast/Brightness Control
Minimum illumination	0.0002 Lux
Options	Built-in PoE (IEEE 802.3af) 24 IR LED

Dimensions

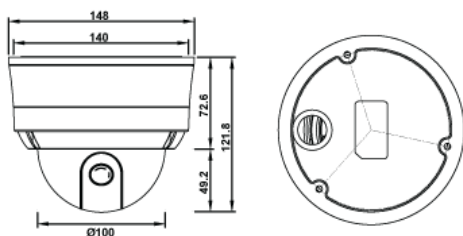

Accessory

