

# DS-7304/7308/7316HI-ST Standalone DVR

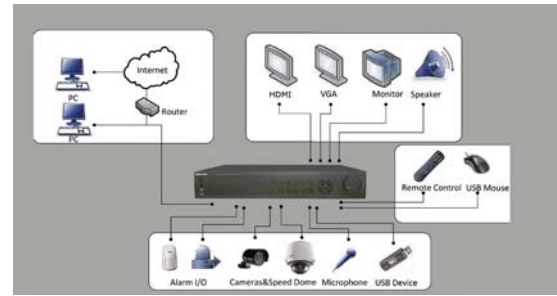

## Key features

- H.264 video compression
- Up to 4CIF resolution recording
- HDMI and VGA output at up to 1920×1080P resolution
- Dual-stream
- 4/8/16-ch synchronous playback
- HDD quota and group management

## Rear Panel of DS-7316HI-ST



1. Main video out, spot video out
2. Video in
3. Audio in
4. Line in
5. CVBS audio out, VGA audio out
6. Video loop out
7. RS-232 interface
8. VGA
9. HDMI
10. USB
11. LAN interface
12. RS-485 serial interface, keyboard interface, alarm in, alarm out
13. eSATA interface
14. GND
15. 100~240 VAC power input
16. Power switch

## Specifications

|                                      | DS-7304HI-ST   | DS-7308HI-ST  | DS-7316HI-ST  |
|--------------------------------------|--|---|---|
| <b>Video / Audio input</b>           |  |   |   |
| Video compression                    | H.264  |   |   |
| Analog video input                   | 4-ch, BNC (1.0 Vp-p, 75 Ω), PAL / NTSC self-adaptive   | 8-ch, BNC (1.0 Vp-p, 75 Ω), PAL / NTSC self-adaptive  | 16-ch, BNC (1.0 Vp-p, 75 Ω), PAL / NTSC self-adaptive   |
| Audio compression                    | G.711  |   |   |
| Audio input                          | 4-ch, RCA (2.0 Vp-p, 1 kΩ)   |   |   |
| Voice talk input                     | 1-ch, RCA (2.0 Vp-p, 1 kΩ)   |   |   |
| <b>Video / Audio output</b>          |  |   |   |
| HDMI output (with HDMI audio output) | 1-ch, resolution: 1080P:1920×1080 /60 Hz; UXGA: 1600×1200 /60 Hz; SXGA: 1280×1024 /60 Hz; 720P:1280×720 /60 Hz; XGA: 1024×768 /60 Hz.  |   |   |
| VGA output                           | 1-ch, resolution: 1080P:1920×1080 /60 Hz; UXGA: 1600×1200 /60Hz; SXGA: 1280×1024 /60 Hz; 720P:1280×720 /60 Hz; XGA: 1024×768 /60 Hz.   |   |   |
| CVBS output                          | 2-ch (1 Main Video Out+1 Spot Video Out), BNC (1.0 Vp-p, 75 Ω), resolution: PAL: 704×576, NTSC: 704×480  |   |   |
| Video loop out (optional)            | 4-ch   | 8-ch  | 16-ch   |
| Encoding resolution                  | 4CIF / 2CIF / CIF / QCIF   |   |   |
| Frame rate                           | Mode1:<br>4CIF @ 15 fps or 2CIF / CIF / QCIF @ 25 fps (P) / 30 fps (N)<br>Mode2:<br>1-ch: 4CIF / 2CIF / CIF / QCIF @ 25 fps (P) / 30 fps (N), 3-ch: CIF / QCIF @ 25 fps (P) / 30 fps (N) | Mode1:<br>4CIF @ 12 fps or 2CIF / CIF / QCIF @ 25 fps (P) / 30 fps (N)<br>Mode2:<br>2-ch: 4CIF / 2CIF / CIF / QCIF @ 25 fps (P) / 30 fps (N) / QCIF @ 25 fps (P) / 30 fps (N) | Mode1:<br>4CIF @ 12 fps or 2CIF / CIF / QCIF @ 25 fps (P) / 30 fps (N)<br>Mode2:<br>4-ch: 4CIF / 2CIF / CIF / QCIF @ 25 fps (P) / 30 fps (N), 12-ch: CIF / QCIF @ 25 fps (P) / 30 fps (N) |
| Video bit rate                       | 32 Kbps ~ 2048 Kbps, or user defined (Max. 3072 Kbps)  |   |   |
| Audio output                         | 2-ch, RCA (Linear, 600 Ω)  |   |   |
| Audio bit rate                       | 64 Kbps  |   |   |
| Dual-stream                          | Support<br>Sub stream: CIF / QCIF  |   |   |
| Stream type                          | Video, Video & Audio   |   |   |
| Playback resolution                  | 4CIF / 2CIF / CIF / QCIF   |   |   |
| Synchronous playback                 | 4-ch   | 8-ch  | 16-ch   |
| <b>Hard disk</b>                     |  |   |   |
| SATA                                 | Up to 4 SATA interfaces  |   |   |
| eSATA                                | 1 eSATA interface  |   |   |
| Capacity                             | Up to 4TB capacity for each disk   |   |   |
| <b>External interface</b>            |  |   |   |
| Network interface                    | 1, RJ45 10M / 100M self-adaptive ethernet interface  |   |   |
| Serial interface                     | 1 RS-232 interface (for parameters configuration, maintenance, transparent channel);1 RS-485 interface (for PTZ control);1 RS-485 keyboard interface (for special keyboard control)      |   |   |
| USB interface                        | 3, USB2.0  |   |   |
| Alarm in                             | 8  | 8   | 16  |
| Alarm out                            | 4  | 4   | 4   |
| <b>General</b>                       |  |   |   |
| Power supply                         | 100 ~ 240 VAC, 5A, 50~60Hz   |   |   |
| Consumption                          | ≤ 25W (without hard disk or DVD-R/W)   | ≤ 30W (without hard disk or DVD-R/W)  | ≤ 35W (without hard disk or DVD-R/W)  |
| Working temperature                  | -10 °C ~ +55 °C  |   |   |
| Working humidity                     | 10% ~ 90%  |   |   |
| Dimensions (W x D x H)               | 440 x 390 x 70 mm  |   |   |
| Weight                               | ≤ 8kg (without hard disk or DVD-R/W)   |   |   |