

DS-9664NI-RH High-end Embedded NVR

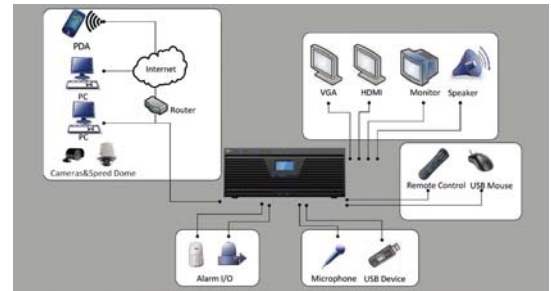

Key features

- Up to 5 Megapixels resolution recording
- HDMI and VGA output at up to 1920×1080P resolution
- RAID0,1,5,10 supported
- 16 SATA interfaces
- Dual Gigabit network interfaces
- Up to dual power supplies

Specifications

DS-9664NI-RH	
Video/Audio input	
IP video input	64-ch
Voice talk input	Mic / Line In, 3.5mm connector
Video/Audio output	
HDMI / VGA output	1-ch, resolution: 1920 x 1080P / 60Hz, 1600 x 1200 / 60Hz, 1280 x 1024 / 60Hz, 1280 x 720 / 60Hz, 1024 x 768 / 60Hz
Encoding resolution	5MP / 3MP / 1080P / UXGA / 720P / VGA / 4CIF / DCIF / 2CIF / CIF / QCIF
Audio output	1-ch, 3.5 mm connector
Synchronous playback	4-ch 4CIF / 1-CH 5MP / 3MP / 1080P / UXGA / 720P
Hard disk	
SATA	16 SATA interfaces
eSATA	1 eSATA interface
Capacity	Up to 3TB capacity for each disk
Disk array	
Array type	RAID0, RAID1, RAID5, RAID10
External interface	
Network interface	2 RJ-45, 10/100/1000Mbps self-adaptive Ethernet interface
Serial interface	1 RS-232 interface (for parameters configuration, maintenance, transparent channel); 1 RS-485 interface (for PTZ control); 1 RS-485 keyboard interface (for special keyboard control)
USB interface	4, USB 2.0
Alarm in	16
Alarm out	8
General	
Power supply	100 ~ 240 VAC, 6.3 A, 50~60 Hz (dual power supplies optional)
Consumption	Single Power Supply ≤ 85 W Dual power supplies ≤ 115 W (without hard disk or DVD-R/W)
Working temperature	-10 °C ~ +55 °C
Working humidity	10% ~ 90%
Dimensions (W x D x H)	442 x 513 x 155 mm
Weight	≤ 18 Kg (without hard disk or DVD-R/W)

Rear Panel of DS-9664NI-RH

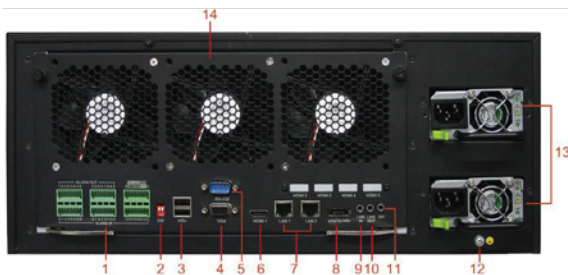

1. RS-485 serial interface, keyboard interface, alarm in, alarm out
2. Termination switch
3. USB interface
4. VGA interface
5. RS-232 serial interface
6. HDMI interface
7. LAN1, LAN2 network interface
8. eSATA/USB interface
9. Line in
10. Line out
11. Mic audio in
12. GND
13. 100 ~ 240V AC input
14. Fan modules