

SN-IPV57/80ECDR

12MP Anti-Distortion Fisheye



- 1/1.7" Progressive Scan CMOS
- 20fps@12MP(4000*3000)
- Triple Streams
- Unique De-warping Image
- Image distortion correction
- Support Camera & Software De-warping
- Low bitrate ,Excellent low light performance
- dWDR,3D DNR
- ROI, Defog, HLC, Corridor mode, DIS
- IP66

System Overview

Sunell fisheye camera is an expert at panoramic surveillance with high-profile design. With a fisheye lens, the camera can provide a high quality 180° or 360° panoramic views without blind spots, making it ideal for wide and open areas, such as airports, shopping malls, banks, hotels, stores, offices and more. The camera can offer different views including 360° overview and de-warp views such as panorama view, double views and quad views.

Functions

Panoramic

Panoramic cameras provide 180 °, 360 ° full range of video scene, and also provide some de-warp mode to bringing people a new sense of real live and interactive experience.

Intelligent Video System (IVS)

With built-in intelligent video analytics, the camera has the ability to detect and analyze moving objects for improved video surveillance. The camera provides optional standard intelligence at the edge allowing detection of Perimeter, Single Virtual Fences, Double Virtual Fences, Loiter, Multi Loiter, Object Left, Object Removed, Abnormal Speed, Converse, Illegal Parking, Signal Bad.

Environmental

With a temperature range of -30 °C to +60 °C (-22 °F to +140 °F), the camera is designed for extreme temperature environments. Subjected and certified to rigorous dust and water immersion tests, the IP67 rating makes it suitable for demanding outdoor applications. For environments with rain, sleet, snow and fog, an integrated wiper provides users with clear visibility at all times.

Smart Encode(H.265+)

Deliver high quality video without straining the network, Smart Encode H.265+ is the optimized implementation of H.265. The Smart H.265+ encoding technology includes a scene adaptive encoding strategy, dynamic GOP, dynamic ROI, flexible multi-frame reference structure and intelligent noise reduction, providing saving of up to 70% of bandwidth and storage when compared with standard H.265.

HEVC (H.265)

H.265 ITU-T VCEG is a new video coding standard. H.265 Following standard developed around the existing video coding standard H.264 , some retain the original technology , while some of the relevant technology to improve the new technology uses advanced technology to improve the relationship between the code stream , encoding quality , and the delay between algorithm complexity , optimize settings specific contents include : Improve compression efficiency , improve the robustness and error recovery capabilities, real-time to reduce the delay, reduce channel acquisition time and a random access delay , reduce complexity.

Technical Specification

Camera	
Image Sensor	1/1.7" Progressive Scan CMOS
Effective Pixels	4000(H)×3000 (V)
Scanning System	Progressive
Electronic Shutter	1/5-1/20000s
Min. illumination	Color:0.009Lux@(F1.2,AGC ON) B/W:0Lux@(IR LED ON)
S/N Ratio	55dB
IR Range	Up to 15m
IR On/Off Control	Auto/ Manual
IR LEDs	6pcs
Pan/Tilt/Rotation Range	N/A
Lens	
Lens Type	Fixed
Iris	Fixed Iris
Focal Length	1.4mm
F Number	F2.4
Angle of View	360°
Focus Control	Fixed
Close Focus Distance	N/A
Video	
Compression	H.265,H.264,MJPEG
Max. Resolution	12MP(4000x3000)
Streaming Capability	2 Streams
Stream / Frame Rate	Stream1: 4000*3000 @20fps, 4096*2160/ 3840*2160/ 3000*3000/ 2560*2560/ 1920*1080 @25fps Stream2: 1280*960/ 720*720/ D1 @25fps
Bit Rate Control	CBR/VBR
Bit Rate	Stream1: 500kbps~16000kbps Stream2: 100kbps~8000kbps
Day/Night	ICR
Image Enhancement	HLC / Defog / dWDR
White Balance	Support
Gain Control	Auto/Manual
Noise Reduction	2D/3D DNR
Electronic Image Stabilization(EIS)	Support
Smart IR	Support
Mirror	Support

Region of Interest	Support
Motion Detection	Support
Privacy Masking	Support
Audio	
Compression	G.711 ,RAW_PCM
Bit Rate	64kbps (G.711), 128kps (RAW_PCM)
Network	
Protocols:	IPv4/IPv6, 802.1x, HTTP, HTTPS, TCP/IP, UDP/IP, RTSP, DHCP, NTP, RTCP/RTP, PPPoE, SMTP, DNS, UPnP, FTP, APR, SNMP
Interoperability	ONVIF
Streaming Method	Unicast
Max. User Access	10 Users
Web Viewer	<IE11, Chrome, Firefox
Management Software	IMS 3.0
Smart Phone	IOS, Android
Intelligence	
IVS	Perimeter, Single Virtual Fences, Double Virtual Fences, Loiter, Multi Loiter, Object Left, Object Removed, Abnormal Speed, Converse, Illegal Parking, Signal Bad
Interface	
Ethernet	1 Ethernet (10/100 Base-T) RJ-45 Connector
Audio Interface	1ch Audio In,1ch Audio Out, 1ch Built-in MIC
Alarm	1ch Alarm In,1ch Alarm Out
RS485	N/A
BNC Output	N/A
Reset Button	Support
Edge Storage	Micro SD/SDHC/SDXC slot ,Max 128GB
Electrical	
Power Supply	DC12V/POE
Power Consumption	3.5W(IR LED OFF), 9W (IR LED ON)
Operating Temperature	Starting Temperature: -30°C ~ 60°C (-22°F ~ 140°F) Working Temperature: -40°C ~ 60°C (-40°F ~ 140°F)
Operating Humidity	Less than 90% RH
Ingress Protection	IP66
Certifications	CE / FCC
Casing	Metal
Dimensions	Φ 130x38.3mm
Net Weight	500g

Dimensions(mm)

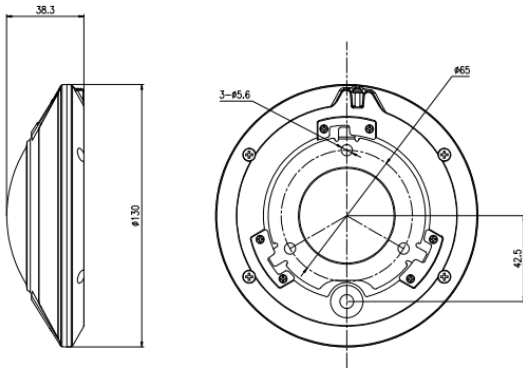

Accessories

Optional:



SN-CBK645A
Junction Box